



7 Nancye Drive Lalor, VIC

 3
  1
  4

## ELEVATED, EUROPEAN STYLE BEAUTY

Proudly presented to the market for the first time in nearly 50 years, there's a certain charm and character to be found in these classic European-style properties. There is certainly a lot to love about this beautifully elevated family home.

Positioned in a quiet well-connected locale, it's easy to see why this neighbourhood is popular with families and all buyers alike with everything you need within close proximity.

Walking distance to local schools including Lalor Gardens, Lalor Hub shops, recreational parklands, sporting facilities, only minutes to Lalor Train station, a short drive to Pacific Epping Plaza Shopping/Dining/Entertainment precinct, COSTCO, Health Services and easy access to major road arterials including the M80 Ring Road Network for that extra commuting convenience to the CBD or out to Melbourne airport.

**Price:** Auction Saturday 16th November at 11:30am  
**Inspect:** Saturday, 9th November 2024 10:00 - 10:30  
 Thursday, 14th November 2024 5:00 - 5:30  
**Auction:** 2024-11-16  
**Details:** 11:30:00



**Jude Kattan**

0450 848 255  
jude.k@lovere.com.au



**Anwar Kattan**

0431 169 844  
anwar.k@lovere.com.au

# 7 Nancye Drive, Lalor

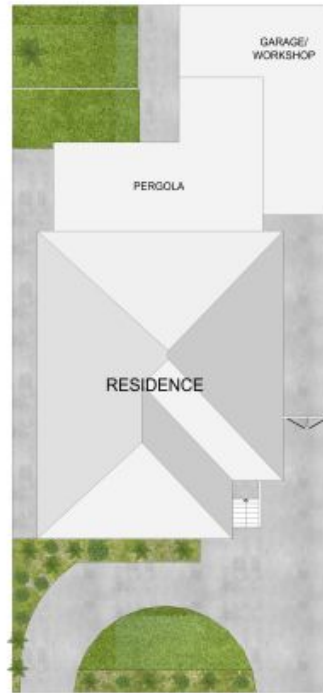

SITE PLAN

THE ABOVE PLAN IS AN ARTIST'S IMPRESSION ONLY, IT INCLUDES ELEMENTS THAT ARE FOR DISPLAY PURPOSES ONLY AND MAY NOT BE TO SCALE. LANDSCAPING SHOWN IS INDICATIVE ONLY. DIMENSIONS ARE APPROXIMATE.