



1 Mapletree Grove Mill Park, VIC



3



1



1

FEDERATION APPEAL

Located in the popular "centenary gardens" development, this lovely single level home within easy walking distance to Westfield shopping centre and train station is ideally situated to first home buyers, investors and downsizers.

Comprises 3 bedrooms, formal lounge, spacious kitchen overlooking tiled meals area and a superb undercover outdoor alfresco providing all year round entertaining. Complete with single lock up garage (currently used as an office), ducted heating, split system air-con and nicely manicured gardens.

Tucked away in a peaceful locale yet close to everything Mill Park has to offer.

Put this on your inspection run!

Price: AUCTION THIS SATURDAY 11AM
Inspect: ~~\$595,000~~ \$650,000 Saturday 24 November 2024 10:30 - 11:00
Auction: 2024-11-09
Details: 11:00:00



Jim Vasiliou

0418 123 054

jim.v@lovere.com.au



John Gioftsidis

0410 522 195

john.g@lovere.com.au

LOVE & CO

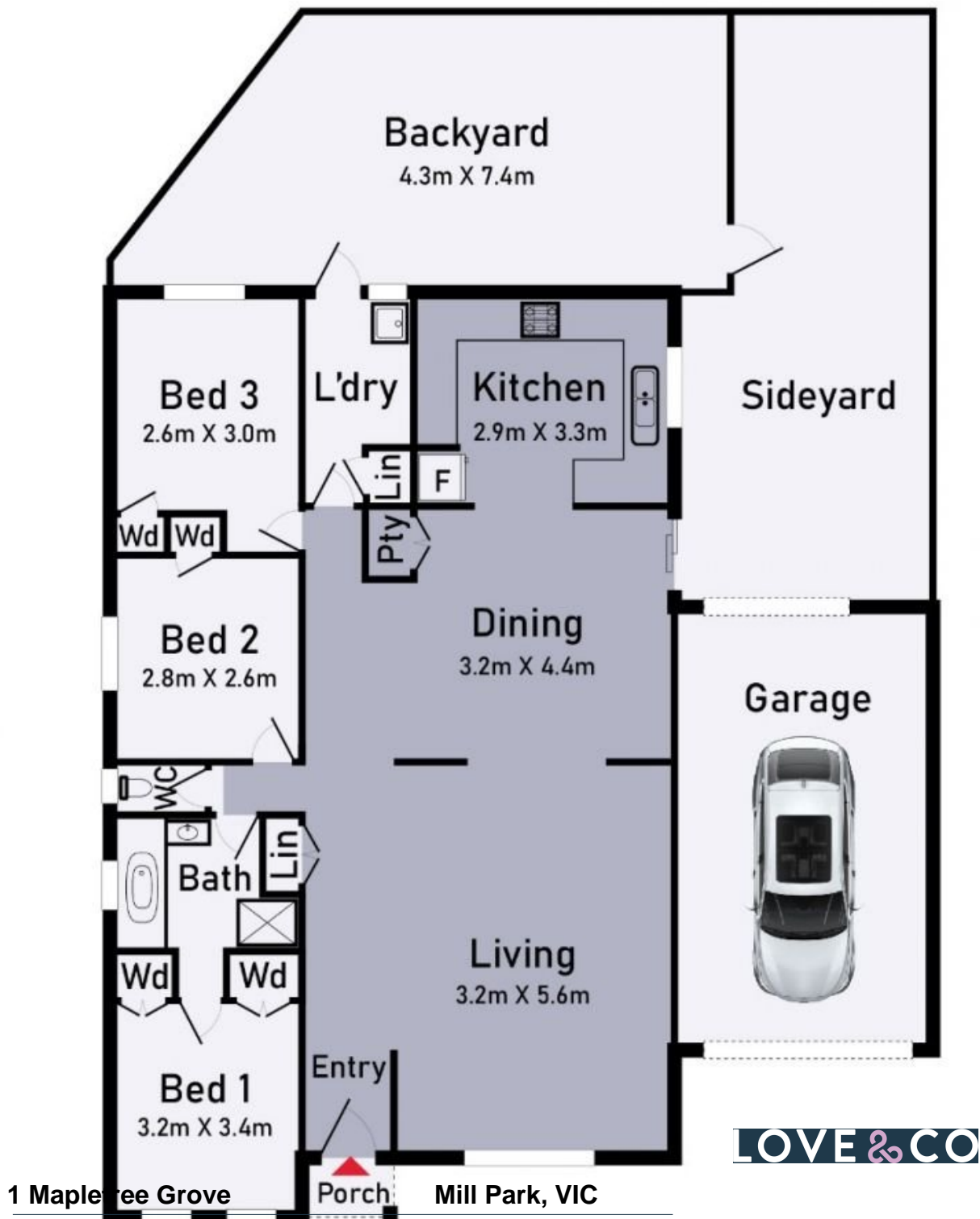

LOVE & CO

1 Mapletree Grove, Mill Park

* Dimensions are approximate and for illustrative purposes only