



2/33 Currajong Street Thomastown, VIC



WALK TO THE TRAIN AND SHOPS

Perfectly positioned within a well maintained residential complex, this terrific single level unit will appeal to a variety of astute looking for affordable living in a central location, where everything you need is all within walking distance.

Leisurely stroll to Thomastown train station, bus services, the vibrant multicultural hub of Station St/May Road shopping precinct, short drive to Pacific Plaza Epping, COSTCO and easy access to major road arterials.

This surprisingly spacious unit offers a light filled open plan design, good sized bedroom with mirrored built in robes, additional bedroom or study, well appointed kitchen with gas cooktop/electric oven, plenty of cupboard space, breakfast bench, living/meals area, central bathroom with combined shower /bathtub, separate laundry and private courtyard with covered alfresco area for your enjoyment.

Features include:

Split system climate control

Price: AUCTION Saturday 26th October at 12:30pm
Inspect: Thursday, 10th October 2024 5:00 - 5:30
Auction: 2024-10-26
Details: 12:30:00



Ilia Menkinoski

0417 528 100

ilia.m@lovere.com.au

2/33 Currajong Street, Thomastown

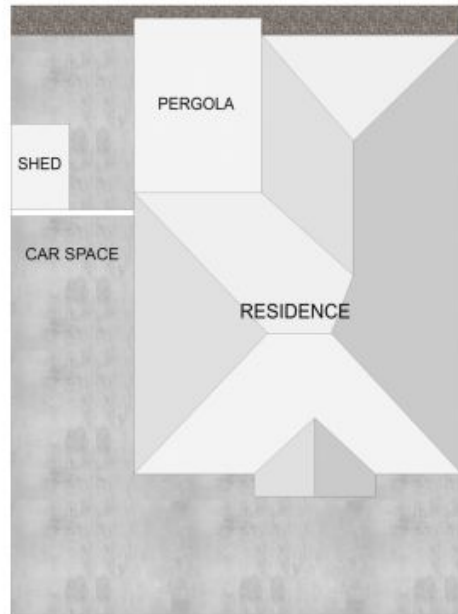

SITE PLAN

THE ABOVE PLAN IS AN ARTIST'S IMPRESSION ONLY, IT INCLUDES ELEMENTS THAT ARE FOR DISPLAY PURPOSES ONLY AND MAY NOT BE TO SCALE. LANDSCAPING SHOWN IS INDICATIVE ONLY. DIMENSIONS ARE APPROXIMATE.

