



3 Celeste Court Berwick, VIC



A Family Entertainer

Impeccable in its presentation, exceptional in its build quality and extremely generous in the amount of space it offers on its beautifully landscaped block, a family lifestyle of the highest calibre awaits once you step inside this magnificent family home. The luxury of versatile living areas accentuates everyday functionality, but it's the presence of a grand kitchen, multiple bathrooms and four robed bedrooms that comfortably accommodates the growing family needs. Polished timber floors flow throughout the airy interior, which begins with a welcoming entrance and separate living space before reaching a fabulous open-plan living domain of incredible proportions. A grand entertainer's kitchen anchors the open-plan living area and achieves maximum wow factor with its feature island breakfast bench, quality appliances and storage, while sliding doors effortlessly unites with an alfresco rear yard, perfect for indoor/outdoor entertaining. This residence also enjoys the benefits of a rumpus room with bar, heating, cooling, ceiling fans, indoor and outdoor entertaining space, remote double garage with internal access and a spacious family laundry with plenty of storage. Conveniently located only a short drive to Parkhill Plaza Shopping Centre, Westfield Fountain Gate, parklands, schools and major arterials.

Price: SOLD - \$985,000

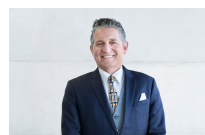

Ross Sullivan
04 0321 0050
ross.s@lovere.com.au

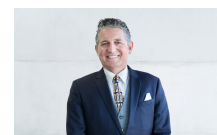

Ross Sullivan
04 0321 0050
ross.s@lovere.com.au

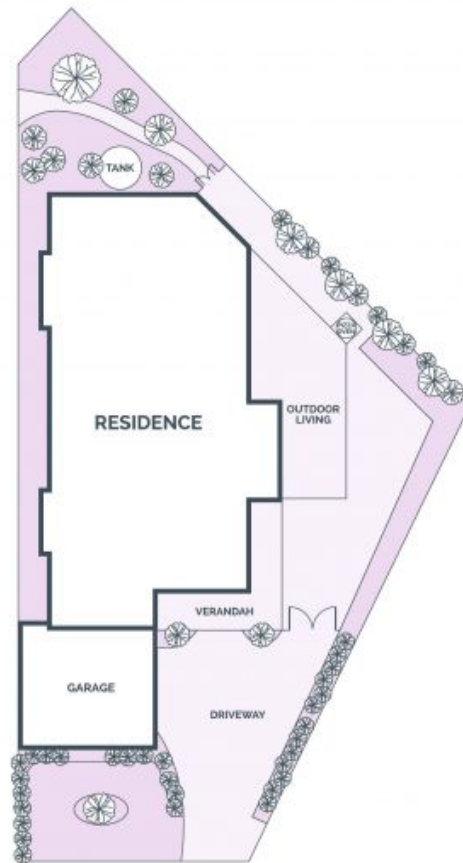

Every precaution has been taken to establish accuracy of the information in this brochure but does not constitute any representation by the vendor or agent.