



8 Belmont Way Mill Park, VIC

3

2

2

Impeccable Townhouse Set Amongst Convenient Surrounds

This immaculately kept townhouse is truly a perfect home for a couple or young family as well as an ideal investment opportunity with a highly sought-after, convenient Mill Park location.

Upon entry, indulge yourself in a bright-and-open ambience throughout a beautifully linked layout consisting of large lounge room, open-plan dining/kitchen area with a seamless integration to the adjacent rear yard with established greenery and undercover zone. Upstairs showcases a perfect master bedroom with walk-in-robe and main bathroom which is flanked by two further robed bedrooms. Freshly painted and with brand new hybrid flooring underfoot, highlights include: ducted heating, evaporative cooling, full-sized laundry, guest powder room, and an oversized remote-controlled garage with internal access.

Price: Sold \$730,000



John Gioftsdis
0410 522 195
john.g@lovere.com.au



Jordan Knight
0434 969 667
Jordan.k@lovere.com.au

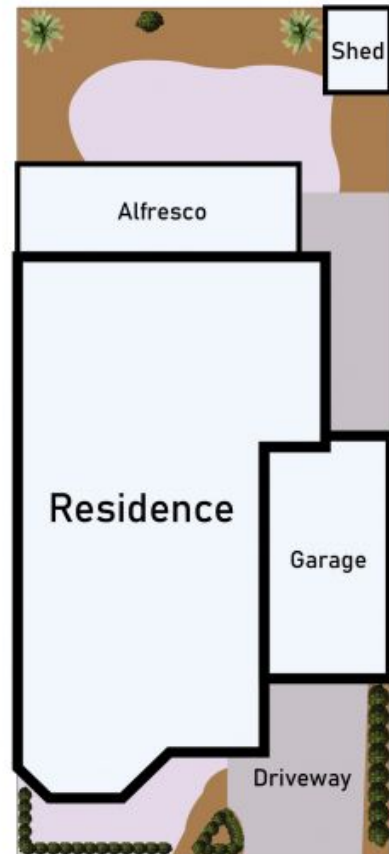
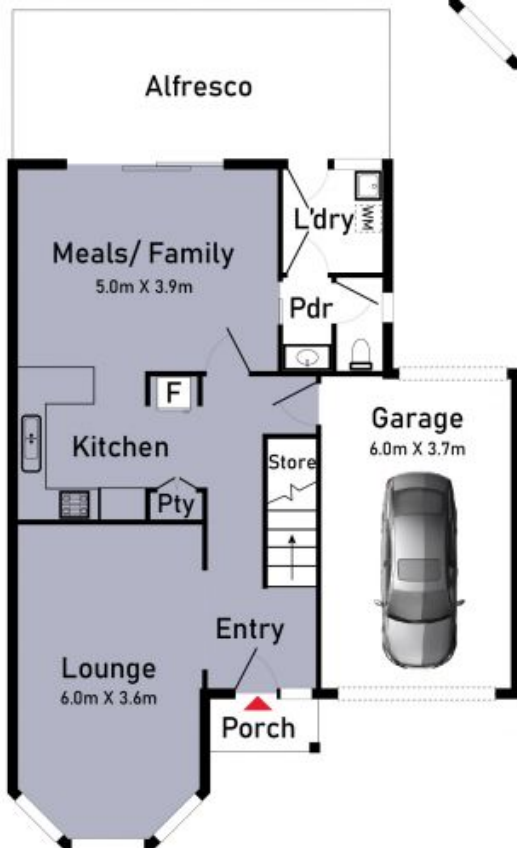
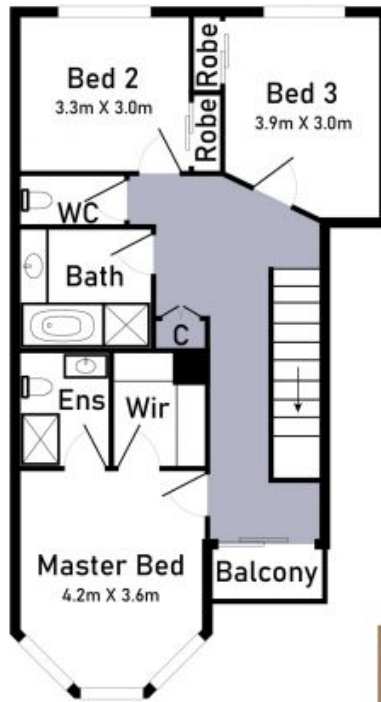

8 Belmont Way, Mill Park

* Dimensions are approximate and for illustrative purposes only

8 Belmont Way

Mill Park, VIC

