



6 Canary Court Mill Park, VIC



Family Friendly And Endlessly Versatile

Fuss-free entry to family-friendly Mill Park is made all the more enticing with this three-bedroom two-bathroom home situated in a quiet cul-de-sac. Set amid landscaped gardens and offering easy alfresco entertaining, this home impresses with its floorplan versatility, two distinct study zones, updated kitchen and wealth of living space. Near Sycamore Park and bike trails, well-regarded schools, buses and the Stables Shopping Centre, this immediately comfortable home invites growing families to settle in for the long term.

- * Quality appliances in central kitchen with copious storage
- * L-shaped living and dining plus sundrenched family living
- * Entertainer's gardens include a sundeck and alfresco space
- * Bedrooms share two bright bathrooms, master with ensuite
- * Two study zones, large third bedroom with its own entry
- * Ducted heating, split system air-conditioner & OSP for two

Price: SOLD - \$704,500



George Theocharis **George Theocharis**

0415 578 809
george.t@lovere.com.au

0415 578 809
george.t@lovere.com.au

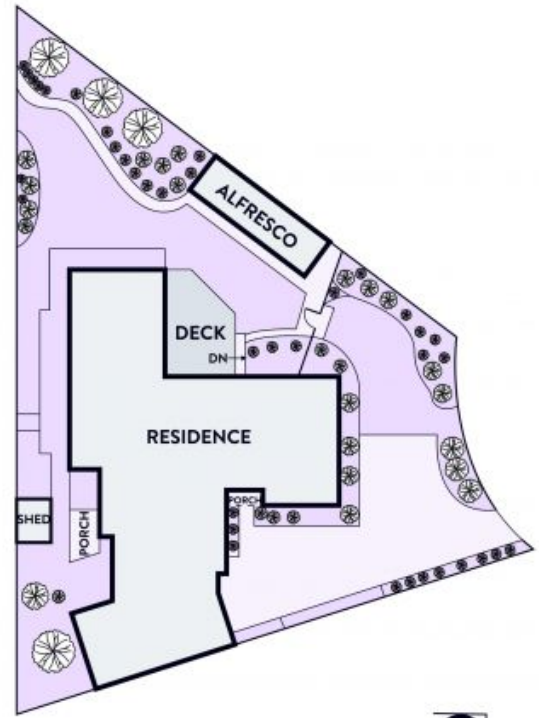

Every precaution has been taken to establish accuracy of the information in this brochure but does not constitute any representation by the vendor or agent.