



1 Metcalf Place Epping, VIC

3 2 1

## Accommodating Family Opportunity

Set between an established front garden and an alfresco focused rear yard where expansive paved areas are complemented by easy-care plants that bring a touch of the tropics, this three-bedroom, two-bathroom home will impress.

Wrapping around a central kitchen that includes a stainless-steel range and plenty of storage and preparation options are two living areas. The spacious lounge-dining finished with quality carpet, is perfectly complemented by a family living, boasting glossy timber floors and sweeping out to an all-weather alfresco. Indoors or out the living and entertaining are easy!

In a location that matches the living, it is a short walk to the secondary college and Greenbrook Village, the bus stops at the end of the street, and the station and Epping Plaza are a short drive or quick bus ride away. Whether you're looking to live in or let out, this is a must-see!

**Price:** \$595,000 - \$650,000



**Jim Kalakias**

0402 177 336  
jim.k@lovere.com.au



**Bijan Rahimi**

0451 515 301  
bijan.r@lovere.com.au

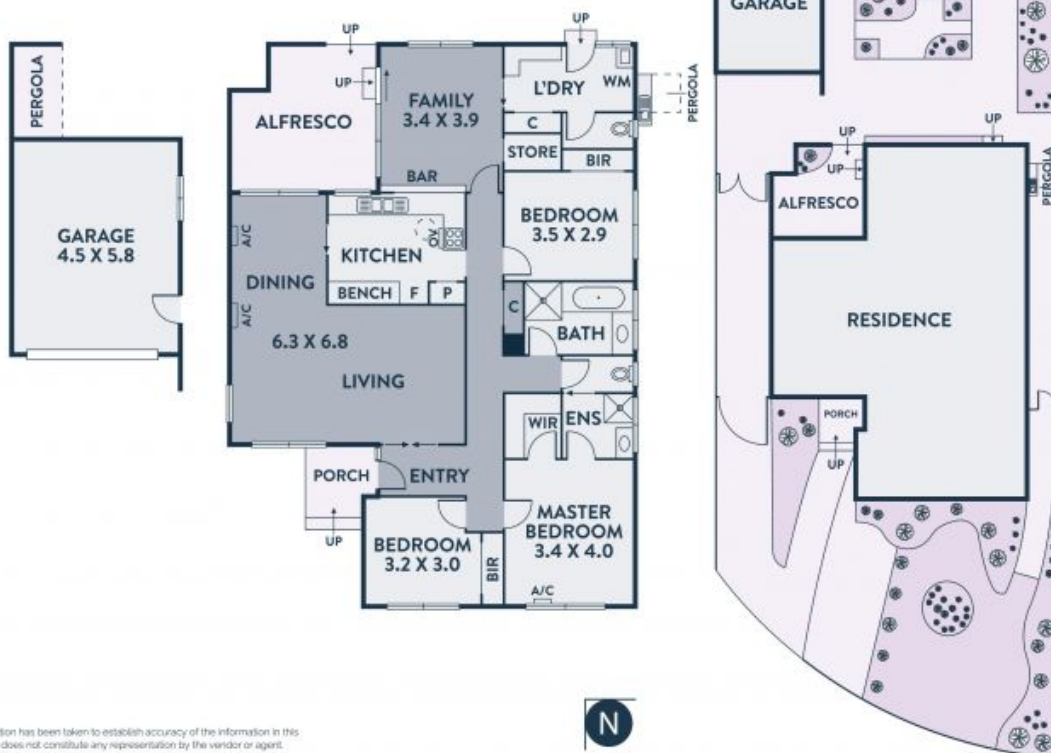

LOVE & CO

1 Metcalf Place

Epping, VIC