



70 Lehmanns Road Wollert, VIC



2



2



1

Contemporary Style And Luxury

Set Negotiation: Wednesday 2nd October at 6:00pm (Unless Sold Prior)

Price:

\$380,000 - \$418,000

This contemporary home on an easy to manage allotment within a few minutes of local shops and schools and a short drive from everything Epping has to offer including the station, delivers an effortless, light filled indoor-outdoor lifestyle. The ground floor introduces generous open plan living anchored by a stone kitchen featuring quality stainless steel appliances and opening to a paved alfresco space in a private rear yard. The first floor offers a bright, light main bedroom with rural outlook, full ensuite and walk-in robe. The second bedroom also enjoys the ease and convenience of its own ensuite!

- Garage with rear roller door
- Ducted refrigerated climate control
- Engineered timber floors to spacious living



George Stathopoulos

0403 053 836

george.s@lovere.com.au



Jim Kalakias

0402 177 336

jim.k@lovere.com.au

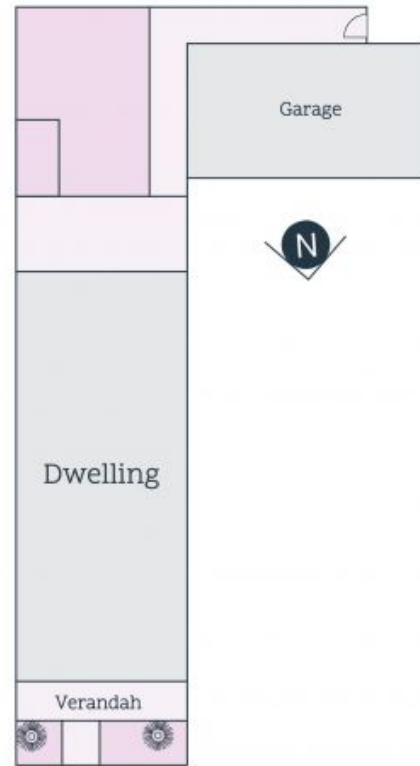
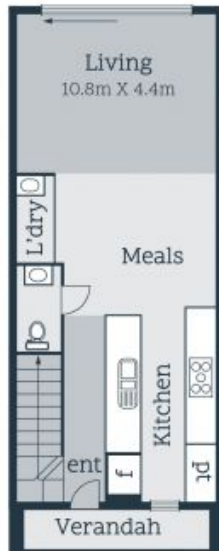
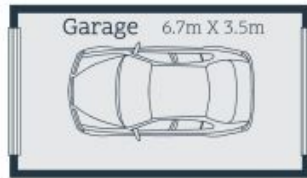

Site Plan

Every precaution has been taken to establish accuracy of the information in this brochure but does not constitute any representation by the vendor or agent