



1 Howqua Court Epping, VIC

 2  1  1

Affordable, Comfortable and Convenient

This single level north facing home in a whisper quiet court is without doubt one of the area's most enticing opportunities for investors, young families or retirees seeking a lock and leave lifestyle.

Private, peaceful, well-proportioned and positioned, offering a generous sized formal lounge with a seamless transition into a generous family meals area overlooked by a pristine kitchen, complemented by a large, paved entertainment area in a low maintenance rear yard.

The two bedrooms, are larger than normal, with the main enjoying, direct access to the sparkling family bathroom. The garage offers front electrical roller door and internal access to through the laundry. Also featuring ducted heating, evaporate cooling and wall heater in the kitchen dining area.

Price: \$400,000 - \$420,000



Jim Kalakias
0402 177 336
jim.k@lovere.com.au



Bijan Rahimi
0451 515 301
bijan.r@lovere.com.au

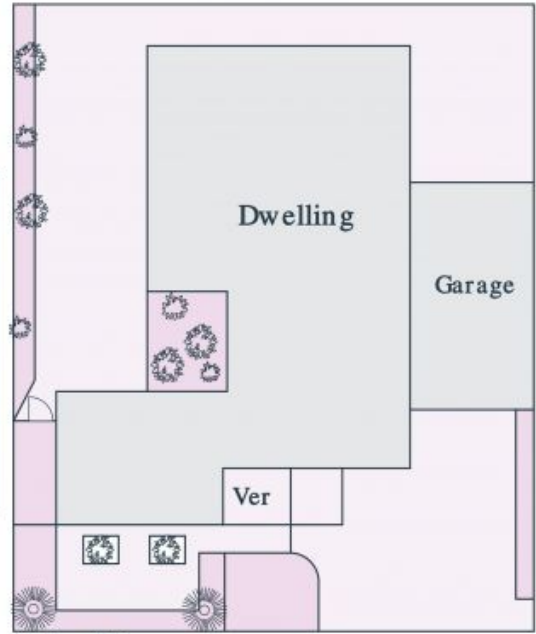

Site Plan

Every precaution has been taken to establish accuracy of the information in this brochure but does not constitute any representation by the vendor or agent

