



15 McFarlane Crescent Epping, VIC



### Irresistible Opportunity In An Impressive Location

Nestled on a generous allotment this absolutely immaculate, one owner home introduces spacious proportions for today and wonderful potential to undertake a contemporary update when time and budget allow.

Glossy solid timber floors, decorative cornice and unmarked paintwork enhance a traditional "L" shaped lounge dining, three bedrooms all with built in robes served by a pristine bathroom, formal lounge dining and a perfectly presented kitchen overlooking a family living zone. Sliding doors allow for easy access to a covered alfresco zone in a private rear yard introducing yet another entertainment area and a shed complementing the carport.

Just a few minute's drive or bus trip from the station, a location an easy walk to the bus, Greenbrook Village, primary and secondary schools and the Epping station introduces a highly desirable lifestyle opportunity in an exceptional discovery for first-home buyers.

**Price:** \$560,000 - \$595,000



**George Stathopoulos** **Jim Kalakias**

0403 053 836  
george.s@lovere.com.au

0402 177 336  
jim.k@lovere.com.au

# 15 Mc Farlane Crescent, Epping

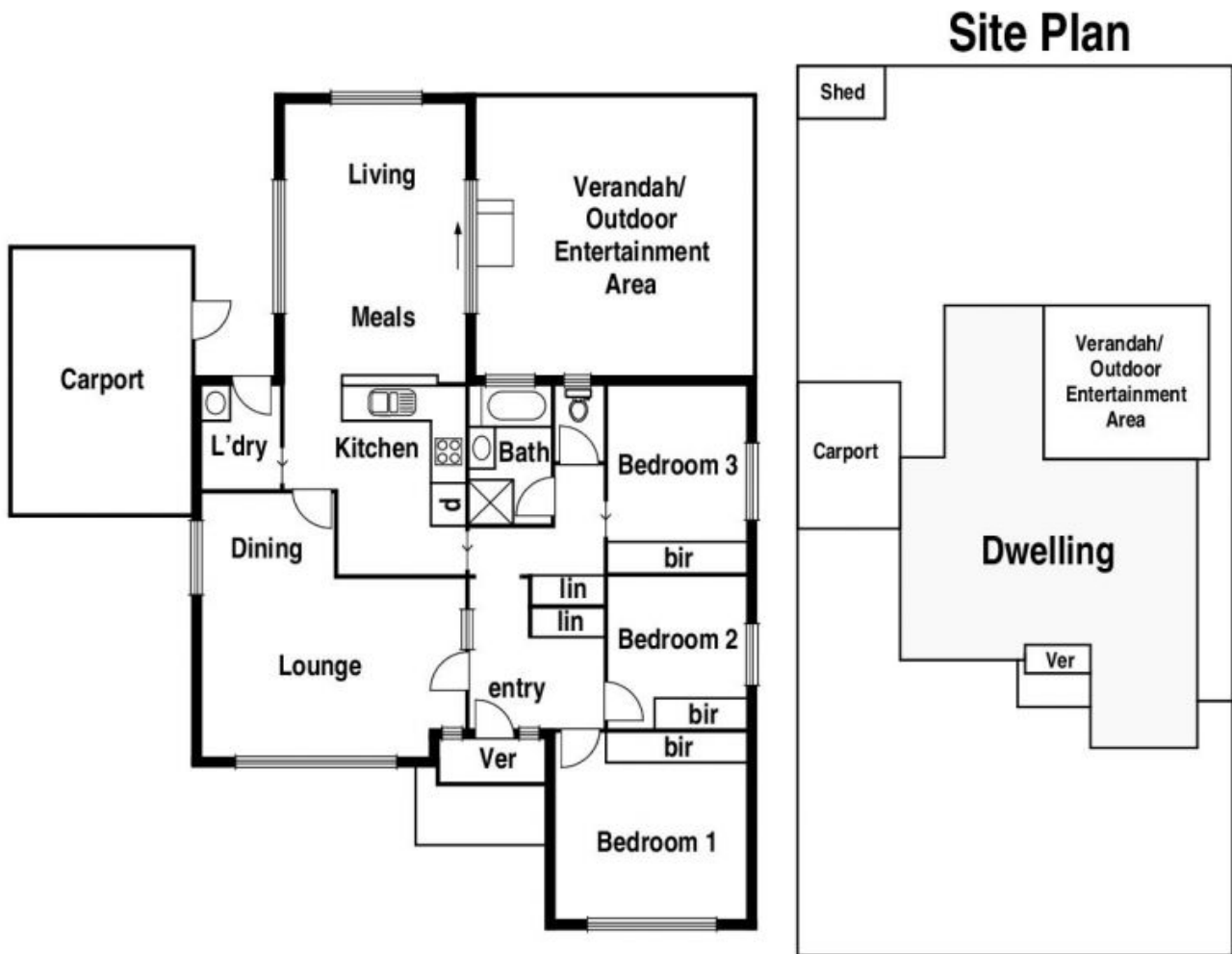

The information contained herein has been obtained through sources deemed to be reliable but cannot be guaranteed.

**LOVE & CO**

15 McFarlane Crescent Epping, VIC