



90 Murray Road Preston, VIC

2 1 2

Timeless Clinker With Options!

- 10 minute walk to Tram
- Close to Northlands Shopping Centre
- Corner allotment of 460m2 (approx)
- Timeless black and white kitchen
- Garage
- Low maintenance rear yard

Price: \$799,900

Positioned in a convenient location this charming clinker has a lot to offer for all buyers. On a corner allotment of 460m2 approx. with two driveways the home consist of two large bedrooms, open plan kitchen/meals/living, leisure area, large bathroom with spa bath and a undercover entertaining area, perfect for those coming summer BBQs.

Additional features include wood fire heater, walk in pantry, L/U garage, decorative cornices as well as being within walking distance to Plenty Road Tram and Northlands Shopping Centre.



Michael Love
0400 106 577
michael.l@lovere.com.au



Graham Love
0418 534 450
graham.l@lovere.com.au

90 Murray Rd. Preston

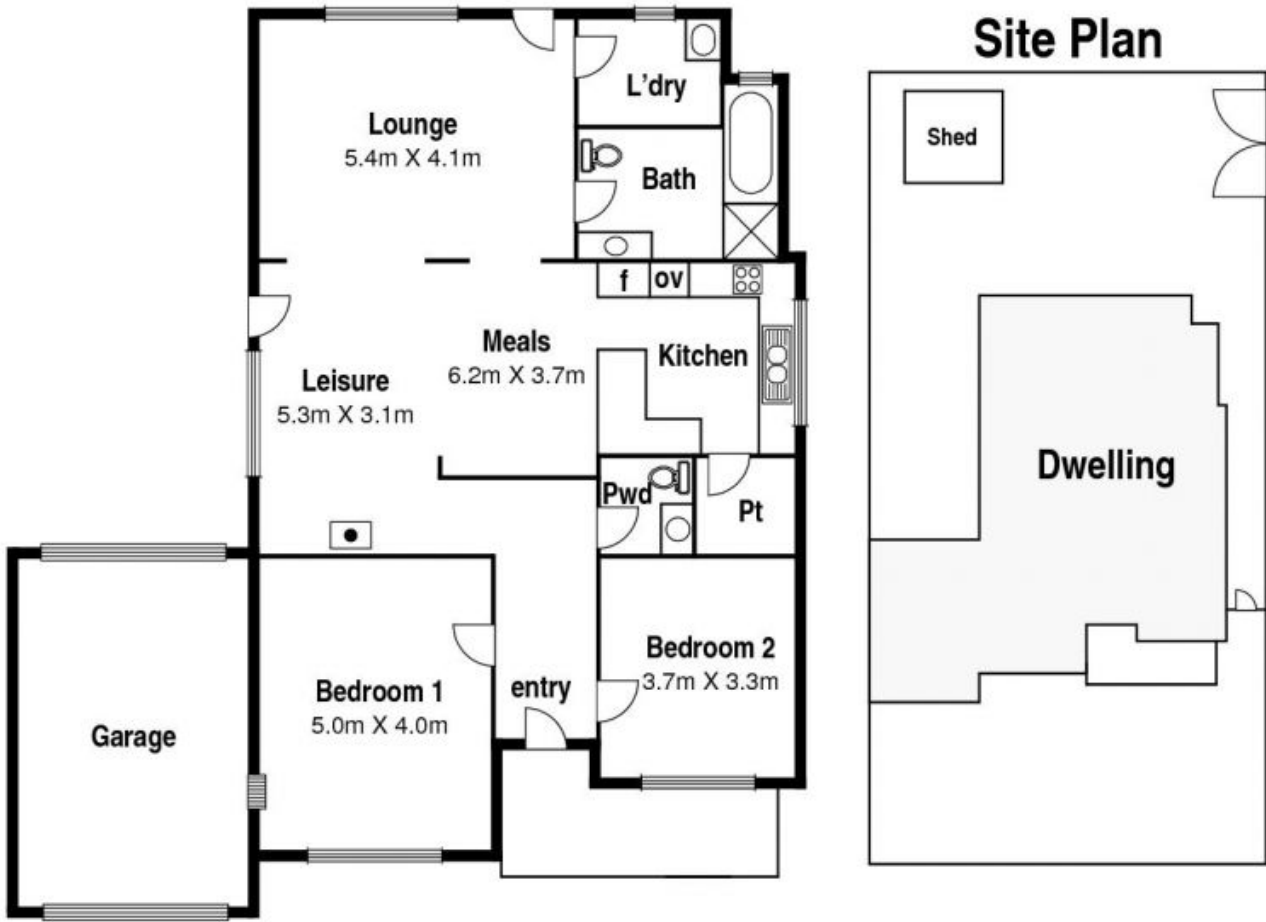

The information contained herein has been obtained through sources deemed to be reliable as to its accuracy. Any information of special interest should be obtained through independent verification.



90 Murray Road

Preston, VIC