



14 Emerald Walk Bundoora, VIC



3



1



2

A Gem On Greswell Grange

Ideal for couples and families with busy lifestyles, this three bedroom town residence's stylish low maintenance interior is enhanced by park-like spaces out the front, a golf course two doors away and La Trobe Uni, the tram and Polaris Shopping Centre all within easy reach. Set in the highly popular Gresswell Grange, the double storey floorplan delivers formal and casual living spaces that complement an alfresco area in the no maintenance rear yard. Upstairs opens to three robed bedrooms, with the main enjoying direct access to the family bathroom.

Adding to the flexibility the double carport, secure behind a roller door, can do double duty as a second undercover precinct if required. With a features list including ducted heating and cooling and timber floors, it's a tempting townhouse to make your own or a perfect prospect for the investor.

Price: \$450,000 - \$500,000

LOVE & CO

Love Reservoir

reservoir@lovere.com.au

14 Emerald Walk, Bundoora

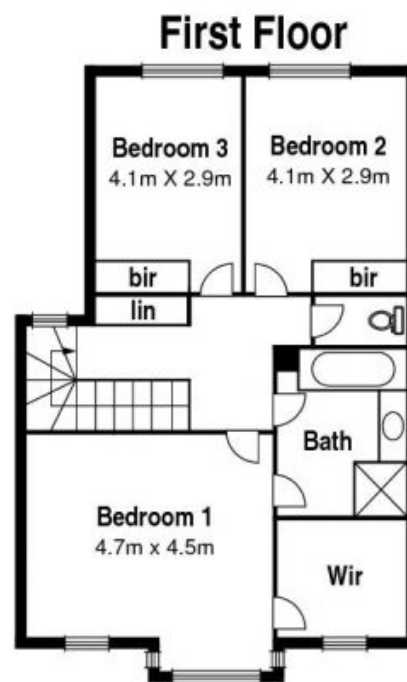
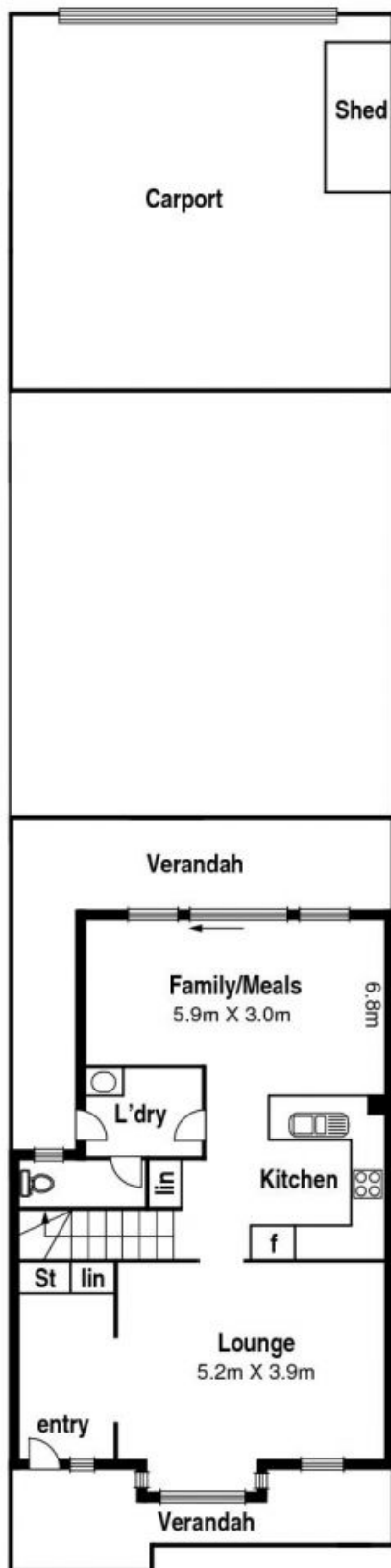

LOVE & CO